

# HR-8402E

4" Low Voltage New Construction Housing  
120V – Non-IC – Electronic

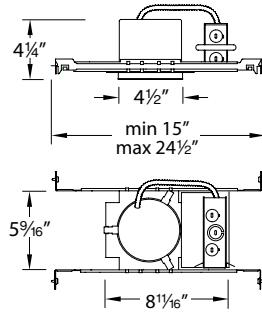

Fixture Type:

Catalog Number:

Project:

Location:

## PRODUCT DESCRIPTION

120V input, non-IC new construction housing with electronic transformer. For use with 4" trims.

## FEATURES

- Cutout: 4<sup>9</sup>/<sub>16</sub>"
- Integral electronic transformer
- May be dimmed with electronic low voltage (MLV) dimmer
- J-Box and transformer accessible through ceiling
- Advanced auto-reset, soft start and short circuit protection features
- Supplied thermal protector protects against over-lamping
- Suitable for 2 x 6 joist installations, for use in "shallow" applications
- 5 year WAC Lighting product warranty

## ORDER NUMBER

**HR-8402E**

## SPECIFICATIONS

**Construction:** Housing is 20 gauge steel, painted black. Frame, junction box and hanger bars are heavy gauge galvanized steel. Ceramic bi-pin socket, 18 gauge teflon insulated wires with fiberglass sleeves.

**J-Box:** Seven knockouts and four Romex® style wiring connectors provided for ease of installation. Rated for branch and chain wiring.

**Transformer:** Electronic, 120VAC 50/60Hz input, 12V/50W max output. Soft start feature extends lamp life by delaying the abrupt inrush current.

**Lamp:** Utilizes 12V/50W max MR16 lamps (order separately).

**Mounting:** Supplied with hanger bars, adjustable from 15"-24<sup>1</sup>/<sub>2</sub>" to accommodate various joist construction and grid sizes. Hanger bars have nailers for wood joists as well as slots for easy mounting on "T" bars. Accommodates surface up to 3/4" thick. 4<sup>9</sup>/<sub>16</sub>" cutout hole.

**Dimming:** May be dimmed with magnetic low voltage (MLV) dimmer.

**Rating:** Non-IC: insulation must be kept at least 3" away from the housing.

**Standards:** UL & CUL Listed, Suitable for damp locations.

## COMPATIBLE TRIMS

Model #	Description	Finish – (where there is a slash (/) the letters correspond as: interior finish/ exterior finish)
HR-D411	Round, step baffle, 35° adjustable	Black/Brushed Nickel (BK/BN), Black/White (BK/WT), White/White (WT/WT)
HR-D412	Round, open reflector, 35° adjustable	Black/Brushed Nickel (BK/BN), Specular Clear/Brushed Nickel (SC/BN), Specular Clear/White (SC/WT)
HR-D412-S	Square, open reflector, 35° adjustable	Specular Clear/Brushed Nickel (SC/BN), Specular Clear/White (SC/WT)
HR-D413	Round, slotted trim, 35° adjustable	White (WT)
HR-D414	Round, eyeball, 30° adjustable	White/White (WT/WT)
HR-D415	Round, pinhole	Black/White (BK/WT), White/White (WT/WT)
HR-D416	Square, directional spot, 30° adjustable	Black (BK), Brushed Nickel (BN), White (WT)
HR-D417	Round, gimbal ring, 25° adjustable	Black (BK), Brushed Nickel (BN), White (WT)
HR-D418	Round, drop dish glass dome, shower	Copper Bronze (CB), White (WT)
HR-D418-S	Round, clear flat lens, 35° adjustable, shower	White (WT)
HR-D419	Round, wall wash, 25° adjustable	Black/White (BK/WT), White/White (WT/WT)
HR-D420	Round, clear acrylic disc	Chrome (CH)
HR-D423	Round, etched glass ring	Amber (AM), Blue (BL), White (WT)
HR-D425	Round, directional spot, 80° adjustable	Black (BK), Brushed Nickel (BN), White (WT)
HR-8411	Round, step baffle, 35° adjustable	Brushed Nickel (BN), Copper Bronze (CB), White (WT), White/White (WT/WT)
HR-8412	Round, open reflector, 35° adjustable	Brushed Nickel (BN), Clear (CL)
HR-8414	Round, eyeball, 35° adjustable	White (WT), White/White (WT/WT)
HR-8417	Round, gimbal ring, 25° adjustable	Black (BK), Brushed Nickel (BN), Copper Bronze (CB), White (WT)

See individual trim spec sheets for complete information.

WAC Lighting  
www.waclighting.com  
Phone (800) 526.2588 • Fax (800) 526.2585

Headquarters/Eastern Distribution Center  
615 South Street • Garden City, NY 11530  
Phone (516) 515.5000 • Fax (516) 515.5050

Western Distribution Center  
168 Brea Canyon Road • City of Industry, CA 91789  
Phone (800) 526.2588 • Fax (800) 526.2585