

WAC LIGHTING

Low Voltage ME-007

LED MR16 Display Spot Light 3000K

Model & Wattage

ME-007 50W
ME-007LED 8W

Finish

BK Black
BN Brushed Nickel
WT White

Example: **ME-007-BK**

DESCRIPTION

Single Spot Light with electronic transformer. Engineered with an integral transformer and designed for mounting to walls or ceilings, low and line voltage Display Spot Lights deploy optimal accent lighting from surface mounted canopies that can be custom designed with any of WAC low voltage track heads.

FEATURES

- Integral electronic transformer
- Accepts 12V LED MR16
- LED MR16 included when ordered as LED
- 1 watt minimum load
- Fixtures available with 6", 12", 18", 24", 36", and 48" extensions
- Special lens types such as spread lenses and UV lenses can be ordered from WAC and used in place of the supplied clear lens.
- Transformer concealed within the fixture
- 5 year warranty

SPECIFICATIONS

Construction:	Die cast Aluminum
Power:	8W, 50W
Input:	120 VAC, 50/60Hz
Dimming:	ELV: 100-10%
Light Source:	LED MR16 (Order separately), LED MR16 (Included)
Rated Life:	50000 Hours
Mounting:	Mounts directly to junction box, Can be mounted on ceiling or wall in all orientations
Finish:	Electrostatically Powder Coated:Black, Electrostatically Powder Coated::Brushed Nickel, Electrostatically Powder Coated::White
Operating Temp:	-4°F to 104°F (-20°C to 40°C)
Standards:	UL, cUL, Damp Location Listed

Fixture Type: _____

Catalog Number: _____

Project: _____

Location: _____



FINISHES:



LINE DRAWING:

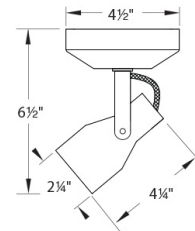

WAC LIGHTING

Low Voltage ME-007

LED MR16 Display Spot Light 3000K







Fixture Type: _____

Catalog Number: _____

Project: _____

Location: _____

ACCESSORIES

	<i>Model</i>	<i>Description</i>	<i>Finish</i>
	LENS-16-RED LENS-16-GRN LENS-16-BLU LENS-16-AMB	Colored Lens Colored Lens Colored Lens Colored Lens	Red Green Blue Amber
	LENS-16-FR	Clear/Frosted Lens	Frosted
	LENS-16-SPR	Spread Lens	Spread Lens
	LENS-16-UVF	UV Filter lens	Clear
	LENS-16-BEL	Beam Elongating Lens	Beam Elongating
	LENS-16-HCL	Honeycomb Louver	Black