

# INSTALLATION INSTRUCTIONS

## VENTRIX - Stealth Cube and Tube

S2SCA-1, S2SCB-1, S2SCC-1, S2STA-1, S2STB-1, S2STC-1



### CAUTION: TO PREVENT ELECTRICAL SHOCK, ENSURE ELECTRICITY HAS BEEN TURNED OFF AT THE CIRCUIT BREAKER BEFORE BEGINNING.

- Read all instructions before installing.
- System is intended for installation by a licensed electrician in accordance with the National Electrical Code (NEC) and local regulations.
- When handling the fixture, do not apply pressure to the LEDs. Hold the fixture by the base only.
- Retain installation instructions for future maintenance reference.
- VENTRIX fixtures and channels feature separate data and power conductor systems. During installation and use, do not short the data or power conductors together by any means or damage may occur.

**WARNING:** All parts must be used as indicated in these instructions. This product is designed for use only with the supplied parts and/or accessories designated for use by WAC Lighting. Substitution of parts or accessories not designated for use with this product by WAC Lighting could result in personal injury or property damage, and will void the warranty. Contact an authorized dealer or the manufacturer if any parts are damaged or missing.

### MISE EN GARDE: POUR ÉVITER TOUT CHOC ÉLECTRIQUE, ASSUREZ-VOUS QUE LE DISJONCTEUR SOIT MIS HORS TENSION AVANT DE COMMENCER.

- Lisez toutes les instructions avant l'installation.
- Le système doit être installé par un électricien licencié conformément au code national de l'électricité (NEC), et également aux règlements locaux.
- Lors de la manipulation du luminaire, n'appuyez pas sur les LED. Tenez-le uniquement par la base.

**ATTENTION:** Toutes les pièces doivent être utilisées comme indiqué dans ces instructions. Ce produit est conçu pour être utilisé seulement avec les pièces et/ou accessoires fournis pour être utilisés avec les produits WAC Lighting. Remplacer des pièces ou accessoires non conçus pour ce produit WAC Lighting pourrait causer des dommages corporels ou matériels et pourrait également causer l'annulation de la garantie. Veuillez contacter un revendeur autorisé ou le fabricant si des pièces manquent ou sont endommagées

### FIXTURE OVERVIEW

VENTRIX Stealth Cube and Tube are intended for use on WAC Lighting's VENTRIX Channel systems.

SPECIFICATIONS	
<b>Input:</b>	48VDC
<b>Installation:</b>	VENTRIX System
<b>Dimming:</b>	Via VENTRIX Connected Power Unit. Refer to CPU Specifications.

### OVERALL FIXTURE DIMENSIONS

#### S2SCA

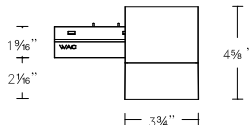

#### S2SCB

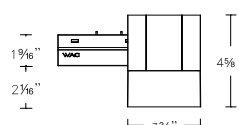

#### S2SCC

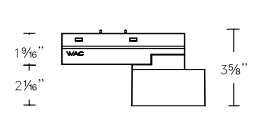

#### S2STA

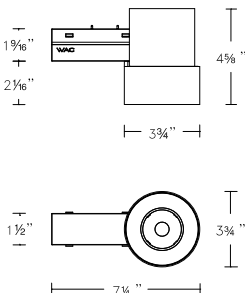

#### S2STB

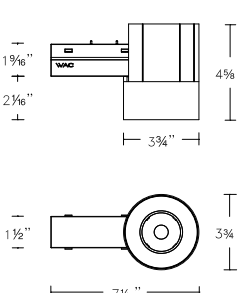

#### S2STC

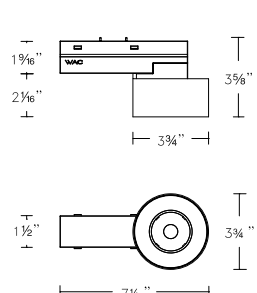

waclighting.com

Phone (800) 526.2588

Fax (800) 526.2585

Headquarters, East Manufacturing Facility

44 Harbor Park Drive

Port Washington, NY 11050

South East Manufacturing Facility

1600 Distribution Ct

Lithia Springs, GA 30122

Central Manufacturing Facility

1700 South J Elmer Freeway, Ste 100

Cedar Hill, TX 75104

West Manufacturing Facility

1750 S Archibald Ave

Ontario, CA 91761

# INSTALLATION INSTRUCTIONS

## VENTRIX - Stealth Cube and Tube

S2SCA-1, S2SCB-1, S2SCC-1, S2STA-1, S2STB-1, S2STC-1

VENTRIX  
BY WAC

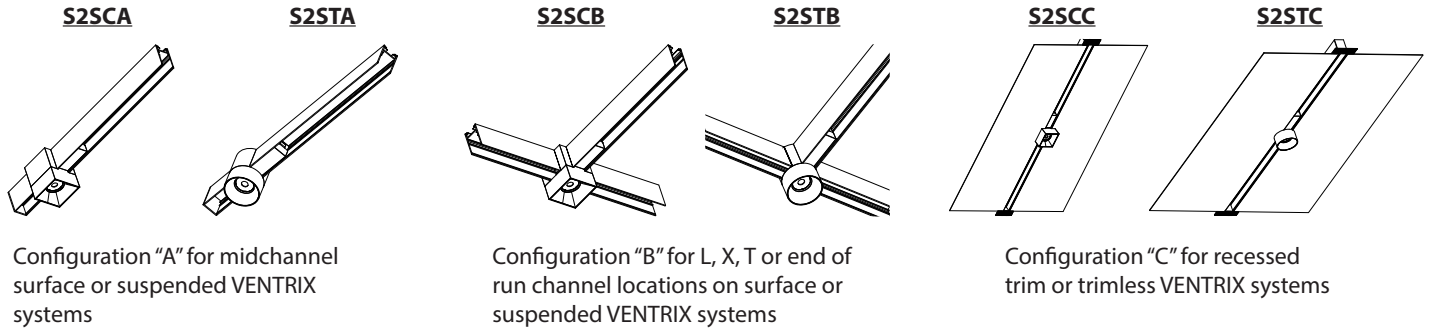

### PREPARATION:

1. Shut off the power at the circuit breaker and ensure adequate room to install the new fixture on the VENTRIX Channel system.
2. Carefully unpack your new fixture and lay out all the parts on a clear area. Be careful not to lose any parts necessary for installation.

### INSTALLATION TO VENTRIX SYSTEM:

The fixture features a VENTRIX adapter for power and mechanical connection to the installed VENTRIX channel system.

1. The Stealth Cube and Tube may be installed into horizontally or vertically mounted VENTRIX channel systems. (See **FIG. 1**).
2. Fixtures are polarity agnostic, and may be installed in VENTRIX channel in either orientation. (See **FIG. 2**).
3. Insert the fixture into the channel slot. Ensure the fixture is parallel to the channel during installation. Push the fixture into the channel until you hear a click and fixture is fully secured. (See **FIG. 3**).

**NOTE:** Fixture adapters also feature magnets to aid in fixture locating. (See **FIG. 3**).

S2SCA and S2STA (Configuration "A") are for mid-channel surface or suspended VENTRIX system. (See **FIG. 4**).

S2SCB and S2STB (Configuration "B") are for L, X, T or end of run channel locations on surface or suspended VENTRIX system. Remove one, two or three panels from the housing top to install SCSCB or S2STB in L, X or T locations. (See **FIG. 4**).

S2SCC and S2STC (Configuration "C") are for recessed trim or trimless VENTRIX systems.

**CAUTION:** Prior to installation in channel, clear any debris from channel bus bar and fixture, particularly on magnetic surfaces. Any conductive elements have potential to cause electrical shorting resulting in damage.

4. Review connection, be sure the fixture body's set of locking tabs is secured in channel prior to finishing installation.

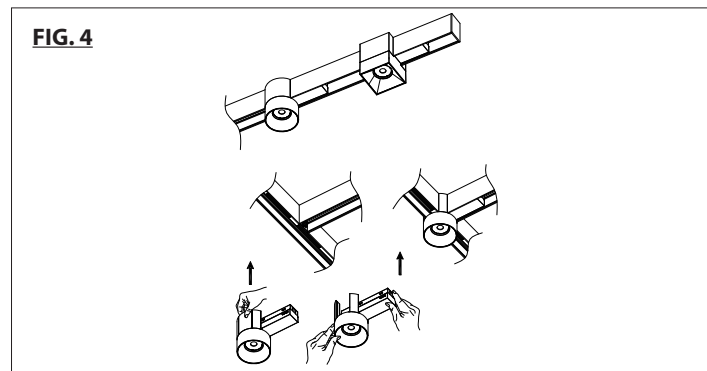
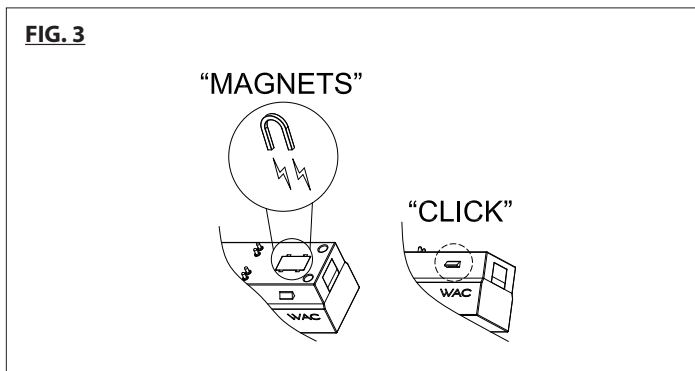
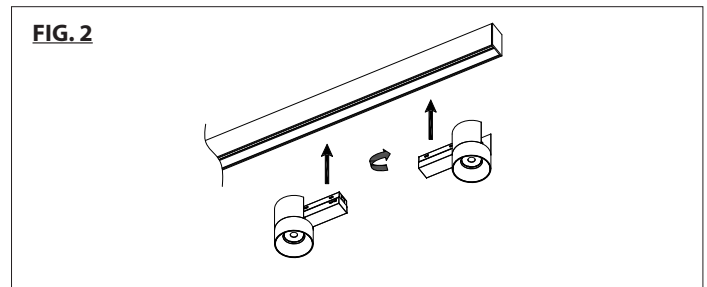
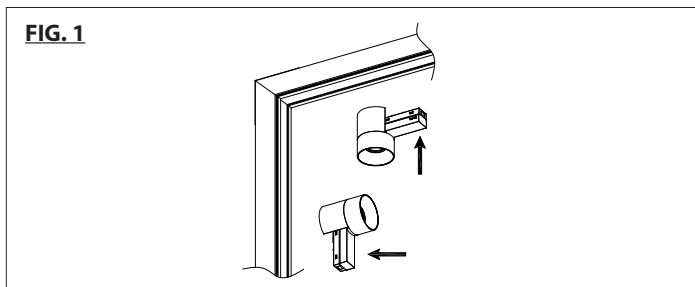

wacighting.com

Phone (800) 526.2588

Fax (800) 526.2585

Headquarters, East Manufacturing Facility

44 Harbor Park Drive

Port Washington, NY 11050

South East Manufacturing Facility

1600 Distribution Ct

Lithia Springs, GA 30122

Central Manufacturing Facility

1700 South J Elmer Freeway, Ste 100

Cedar Hill, TX 75104

West Manufacturing Facility

1750 S Archibald Ave

Ontario, CA 91761

# INSTALLATION INSTRUCTIONS

## VENTRIX - Stealth Cube and Tube

S2SCA-1, S2SCB-1, S2SCC-1, S2STA-1, S2STB-1, S2STC-1

VENTRIX  
BY WAC

### RELOCATING THE FIXTURE IN CHANNEL:

While installed to the VENTRIX system, the fixture may be relocated.

1. By hand, relocate the fixture within a channel by pushing the adapter in the desired direction. (See **FIG. 5**).
2. Fixtures cannot be relocated between channels. It must be removed, repositioned, and then installed from one channel to another. (See **FIG. 6**).

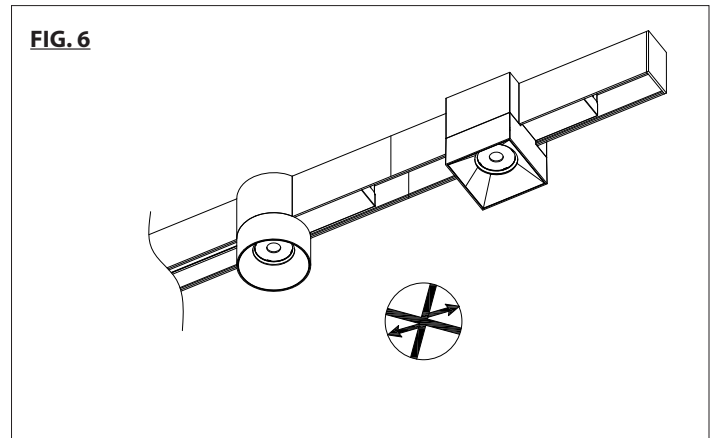
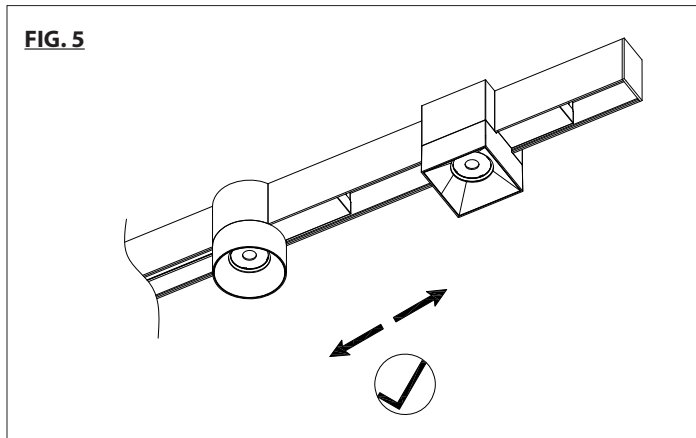

### REMOVING THE FIXTURE FROM THE CHANNEL:

1. By hand, engage and press the push button on the adapter, while holding the other end of the fixture. With push button pressed, pull the fixture away from the channel, until it is clear of the channel (See **FIG. 7**).

**NOTE:** Ensure the adapter is parallel to the channel during removal. Removing the fixture at an angle may result in damage. (See **FIG. 8**).

2. To enable fixture removal from channel, maintain free channel space of 1.5" on each side of adapter to enable access to releasing locking tabs.

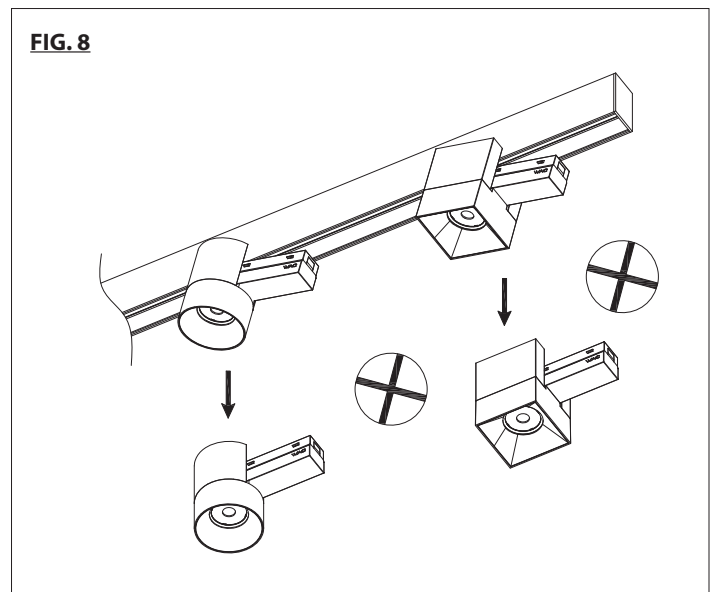
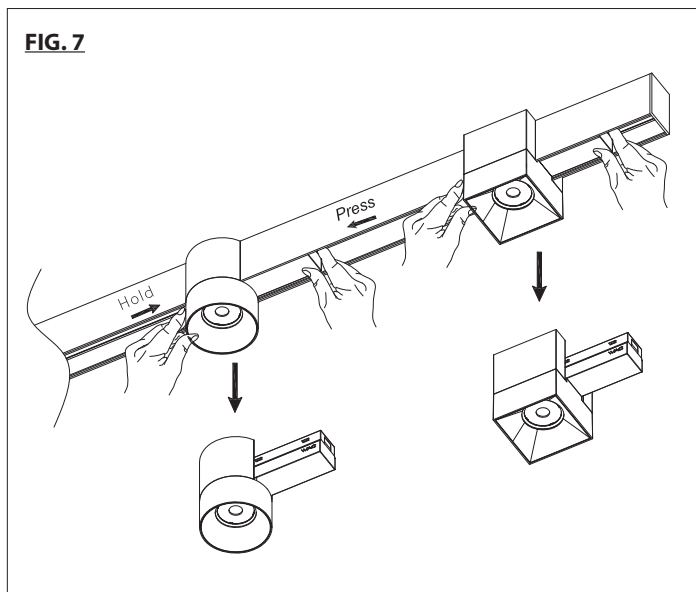

wacighting.com

Phone (800) 526.2588

Fax (800) 526.2585

Headquarters, East Manufacturing Facility

44 Harbor Park Drive

Port Washington, NY 11050

South East Manufacturing Facility

1600 Distribution Ct

Lithia Springs, GA 30122

Central Manufacturing Facility

1700 South J Elmer Freeway, Ste 100

Cedar Hill, TX 75104

West Manufacturing Facility

1750 S Archibald Ave

Ontario, CA 91761

# INSTALLATION INSTRUCTIONS

## VENTRIX - Stealth Cube and Tube

S2SCA-1, S2SCB-1, S2SCC-1, S2STA-1, S2STB-1, S2STC-1



### REPLACING THE TRIM AND TIR LENS:

The Stealth Cube and Tube trims may be replaced in field to change the decorative appearance of the fixture. Its TIR lens may be replaced to change its optical performance.

1. Power off the fixture and allow it to cool down.
2. Using a fingernail, separate the trim and remove it from the fixture housing.
3. Using a small prying tool (such as flat head screwdriver), remove the TIR lens from its holder. Select the appropriate replacement components using model numbers. (See **FIG. 9**).
4. Reverse the above steps to install TIR lens and trim to the fixture housing.

**FIG. 9**

PART. NO	Description
TIR-LUM9-0D50-S	20° Beam angle
TIR-LUM9-0D50-N	38° Beam angle
TIR-LUM9-0D50-F	50° Beam angle

PART. NO	Description
REF-S2SC-BK	Black Trim
REF-S2SC-CH	Ghrome Trim
REF-S2SC-GL	Gold Trim
REF-S2SC-HZ	Haze Trim
REF-S2SC-WT	White Trim

PART. NO	Description
TIR-LUM9-0D50-S	20° Beam angle
TIR-LUM9-0D50-N	38° Beam angle
TIR-LUM9-0D50-F	50° Beam angle

PART. NO	Description
REF-S2ST-BK	Black Trim
REF-S2ST-CH	Ghrome Trim
REF-S2ST-GL	Gold Trim
REF-S2ST-HZ	Haze Trim
REF-S2ST-WT	White Trim

### REPLACING THE LED:

The Stealth Cube and Tube LED may be replaced in field (See **FIG. 10**).

1. Remove the fixture from the VENTRIX channel. Place it on a flat surface with its trim and lens facing upwards and allow it to cool down.
2. Using a fingernail, remove the trim. Using a small prying tool (such as flat head screwdriver), remove the TIR lens from its holder (**FIG. 10A** and **10B**).
3. Using a Phillips screwdriver to loosen two screws and separate the LED holder from the LED. Disconnect the LED wire harness to remove the LED (**FIG. 10C, 10D** and **10E**).
4. Place the LED at the center of the mounting surface, install LED holder using two Phillips screws and connect LED wire harness to the connector inside the housing (**FIG. 10F**).
5. Reverse the previous steps to install TIR lens and trims to the housing.

**FIG. 10**

wacighting.com

Phone (800) 526.2588

Fax (800) 526.2585

Headquarters, East Manufacturing Facility

44 Harbor Park Drive

Port Washington, NY 11050

South East Manufacturing Facility

1600 Distribution Ct

Lithia Springs, GA 30122

Central Manufacturing Facility

1700 South J Elmer Freeway, Ste 100

Cedar Hill, TX 75104

West Manufacturing Facility

1750 S Archibald Ave

Ontario, CA 91761