

# AETHER 2" - Round Adjustable Trim

## R2ARAT



Fixture Type:

Catalog Number:

Project:

Location:

### PRODUCT DESCRIPTION

Shallow housing that is designed to fit in tight plenum spaces without sacrificing lumen output.

### FEATURES

- Designed to fit in tight plenum
- 2" trim aperture, 2" housing height
- Damp Location Trims: 0-30° vertical and 365° horizontal adjustment
- Wet Location Trims: 0-25° vertical and 365° horizontal adjustment
- 5 year WAC Lighting product warranty

### SPECIFICATIONS

- Construction:** Die-cast aluminum trim with die-cast aluminum heat sink
- Dimming:** 100% - 5% with 0-10V  
100% - 5% with Electronic Low Voltage (ELV)/ TRIAC
- Input:** 120V-277V AC
- Power:** 15W, power factor 0.9
- Mounting:** Retention clips firmly hold trim to housing
- Finish:** Powder Coated White, Black/White, Haze/White, Black
- Ceiling thickness:** ½" - 1"
- Standards:** UL & cUL Damp Listed, UL & cUL Wet Listed (Lensed options only), Title 24 JA8 Compliant

| Trim (See next page for housing)                              | Model   | Beam                          | Color Temp                    | CRI                  | Lumens               | CBCP  | Finishes  |
|---|---|-------------------------------|-------------------------------|----------------------|----------------------|---|---|
|   | <b>R2ARAT</b><br>Round, 0-30° Adjustable Damp Location        | N 26°                         | <b>827</b> 2700K 85 1270 4270 | 85<br>85<br>85<br>85 | 1345<br>1375<br>1390 | 4525<br>4635<br>4675  | <b>BK</b> Black/Black<br><b>WT</b> White/White<br><b>BKWT</b> Black/White<br><b>HZWT</b> Haze/White |
|   |   |                               | <b>830</b> 3000K 90 1050 3535 |                      |                      |   |   |
|   |   |                               | <b>835</b> 3500K 90 1095 3680 |                      |                      |   |   |
|   |   |                               | <b>840</b> 4000K 90 1095 3680 |                      |                      |   |   |
|   |   | F 40°                         | <b>827</b> 2700K 85 1260 2515 |                      |                      |   |   |
|   |   |                               | <b>830</b> 3000K 85 1335 2670 |                      |                      |   |   |
|   | <b>R2ARAT</b><br>Round, 0-25° Adjustable Lensed, Wet Location | N 28°                         | <b>835</b> 3500K 85 1370 2735 | 85<br>85<br>85       | 1380                 | 2755  | <b>BK</b> Black/Black<br><b>WT</b> White/White<br><b>BKWT</b> Black/White<br><b>HZWT</b> Haze/White |
|   |   |                               | <b>840</b> 4000K 85 1380 2755 |                      |                      |   |   |
|   |   |                               | <b>927</b> 2700K 90 1045 2085 |                      |                      |   |   |
|   |   |                               | <b>930</b> 3000K 90 1090 2170 |                      |                      |   |   |
|   |   | F 40°                         | <b>827</b> 2700K 85 1175 3680 |                      |                      |   |   |
|   |   |                               | <b>830</b> 3000K 85 1245 3905 |                      |                      |   |   |
| <b>R2ARAT</b><br>Round, 0-25° Adjustable Lensed, Wet Location | N 28°   | <b>835</b> 3500K 85 1275 4000 | 85<br>85<br>85                | 1285                 | 4030                 | <b>LBK</b> Lensed Black<br><b>LBKWT</b> Lensed Black/White<br><b>LHZWT</b> Lensed Haze/White<br><b>LWT</b> Lensed White |   |
|   |   | <b>840</b> 4000K 85 1285 4030 |                               |                      |                      |   |   |
|   |   | <b>927</b> 2700K 90 970 3050  |                               |                      |                      |   |   |
|   |   | <b>930</b> 3000K 90 1015 3175 |                               |                      |                      |   |   |
|   | F 40°   | <b>827</b> 2700K 85 1160 2220 |                               |                      |                      |   |   |
|   |   | <b>830</b> 3000K 85 1230 2355 |                               |                      |                      |   |   |
| <b>R2ARAT</b><br>Round, 0-25° Adjustable Lensed, Wet Location | N 28°   | <b>835</b> 3500K 85 1260 2415 | 85<br>85<br>85                | 1270                 | 2430                 | <b>LBK</b> Lensed Black<br><b>LBKWT</b> Lensed Black/White<br><b>LHZWT</b> Lensed Haze/White<br><b>LWT</b> Lensed White |   |
|   |   | <b>840</b> 4000K 85 1270 2430 |                               |                      |                      |   |   |
|   |   | <b>927</b> 2700K 90 960 1840  |                               |                      |                      |   |   |
|   |   | <b>930</b> 3000K 90 1000 1915 |                               |                      |                      |   |   |
|   | F 40°   | <b>827</b> 2700K 85 1160 2220 |                               |                      |                      |   |   |
|   |   | <b>830</b> 3000K 85 1230 2355 |                               |                      |                      |   |   |

**R2ARAT-** \_\_\_\_\_ - \_\_\_\_\_

Example: **R2ARAT-N930-WT**

Please see next page for housing (required)

# AETHER

## HR-2LED-H13A - Housing



### Housing

### Model

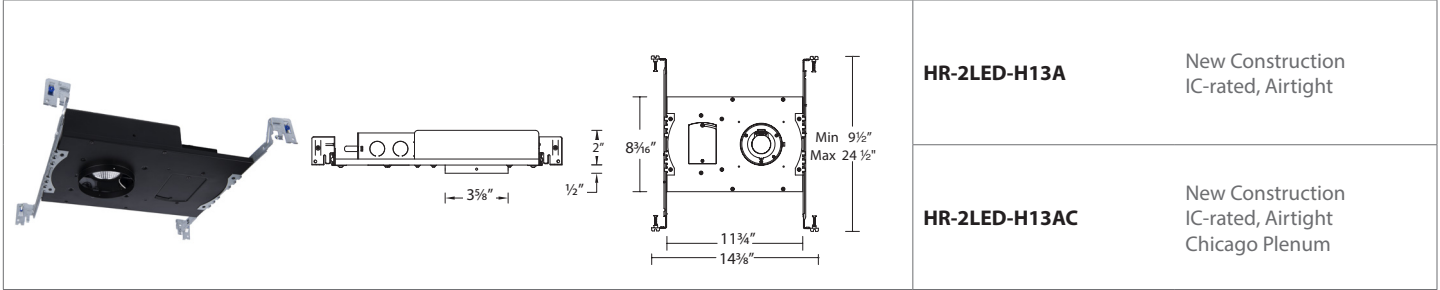

**HR-2LED-H13A**

New Construction  
IC-rated, Airtight

**HR-2LED-H13AC**

New Construction  
IC-rated, Airtight  
Chicago Plenum

### HR-2LED-H13

Example: **HR-2LED-H13A**

wacighting.com

Phone (800) 526.2588

Fax (800) 526.2585

**Headquarters, East Manufacturing Facility**

44 Harbor Park Drive

Port Washington, NY 11050

**South East Manufacturing Facility**

1600 Distribution Ct

Lithia Springs, GA 30122

**Central Manufacturing Facility**

1700 South J Elmer Freeway, Ste 100

Cedar Hill, TX 75104

**West Manufacturing Facility**

1750 S Archibald Ave

Ontario, CA 91761